



BLACK PAW MANUAL CHAIN LEVER HOIST- OPERATION INSTRUCTION

APPLICATION

It is a highly efficient and versatile hand operated hoisting machinery, which is capable of being widely applied in shipbuilding, powerplants, transport, construction-sites, mines, post and telecommunication for installing machine, lifting goods and dragging loads etc. It is particularly used in narrow places. The open air and overhead places for pulling and stretching work at any angle.

USE OF FREE GEARING SYSTEMS

Without any load, set the selector lever to the "N" (neutral) position, the clutch disengaged, pull the load chain smoothly and slowly, thus allowing the lower hook to be adjusted to any desired position. Once give the load chain a quick and sudden pull, the clutch re-engaged.

LIFTING LOAD

Set the selector to "UP" position, operate lever handle to press the friction plates and ratchet disk tightly against the brake seat, drive the driving shaft, disk gear, pinion shaft, splinted gear and load chain to lift the load slightly.

OPERATION INSTRUCTION

1. Do not overload
2. Do not motorize, lever block is designed for hand operation only.
3. All moving parts should always be kept well lubricated before operating, be sure that the various parts are not damaged, and idle motion is in good condition.
4. Before lifting, inspect the hook to see whether it is securely attached. Do not suspend a load at the hook tip. Load chain should not be twisted to ensure safety.
5. Stop operating immediately in case the lever handle force exceeds that of normal operation.
6. Check as follows:
 - A) Whether there is anything entangled with the load.
 - B) Whether there is any trouble with the parts of the block.
 - C) Whether the load is over the rated capacity of the block.

MAINTENANCE

1. After use, clean off the dirt on the block and grease its parts. Keep it in a dry place.
2. Maintenance and inspection should be made by a skilled hand. Never allow any layman to disassemble or assemble the block.
3. After cleaning and repairing, the block should be subjected to idle and heavy tests so as to ensure reliability in use.
4. Keep the friction surfaces of the brake clean. Brake mechanism should be regularly inspected so as to forestall trouble in the brake.

WARRANTY

The manufacturer guarantees that the product is free from defects or malfunctions for a period of one year from the date of purchase. During this warranty period, repairs and replacements for quality-related defects are covered.



BLACK PAW MANUAL CHAIN LEVER HOIST- LEVER PARTS LIST

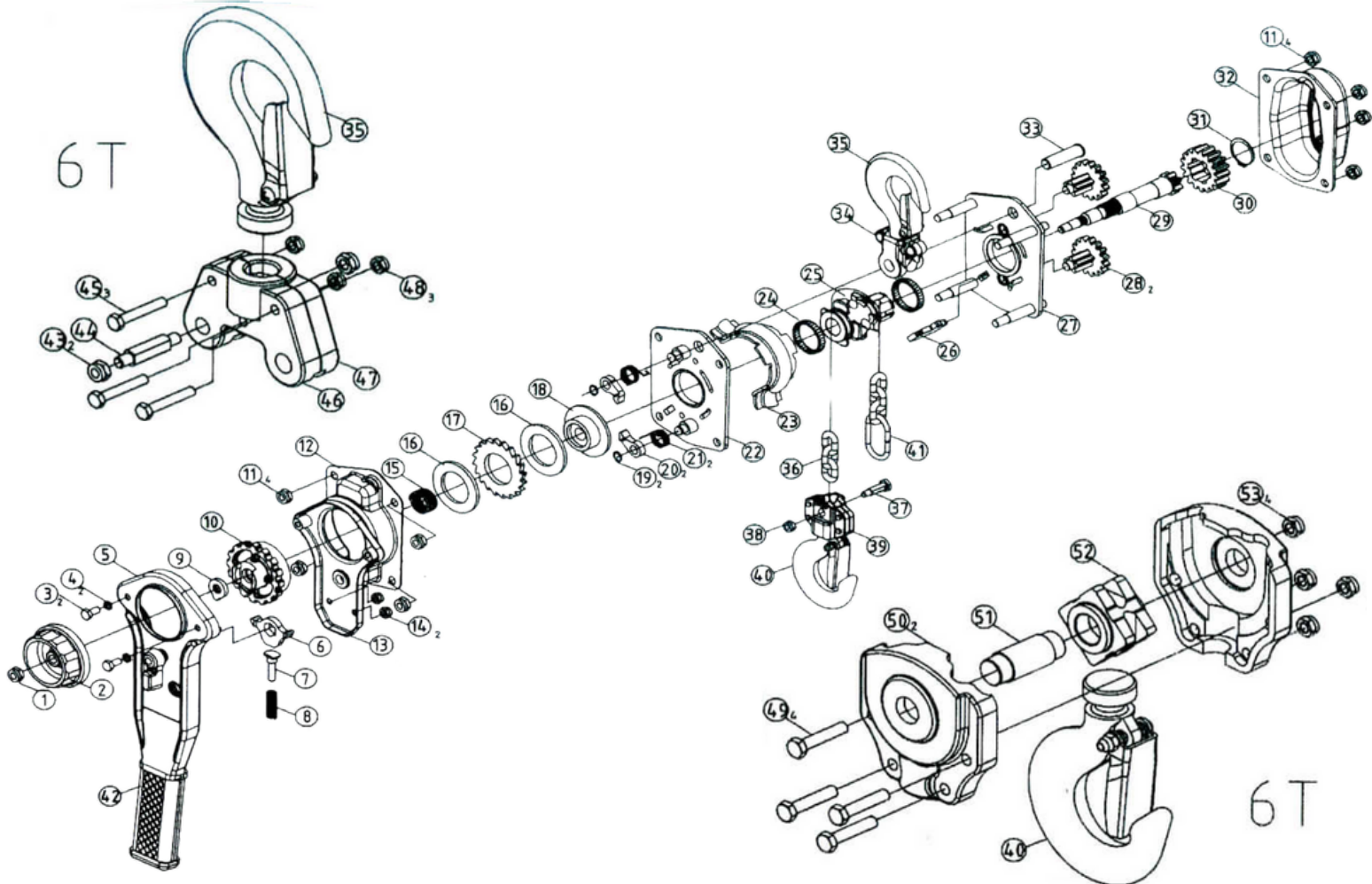

1	Locknut	15	Pinion Shaft Spring	29	Pinion Shaft Spring	43	Locknut
2	Handwheel	16	Brake Disc	30	Splined Gear	44	Top Hook Shaft
3	Screw	17	Ratchet Disc	31	Snap Ring	45	Screw
4	Spring Washer	18	Brake Seat	32	Gear Case Assembly	46	Top Hook Holder A
5	Lever Handle Assembly	19	Snap Ring	33	Top Hook	47	Top Hook Holder B
6	Change Over Pawl	20	Pawl	34	Top Hook Holder	48	Locknut
7	Spring Pin	21	Pawl Pan	35	Top Hook Assembly	49	Screw
8	Change Over Pin	22	Left Side Plate Assembly	36	Load Chain	50	Top Hook Holder
9	Stop Screw	23	Chain Cover	37	Suspension Pin	51	Ladle Shaft
10	Change Over Gear	24	Roller Pin	38	Locknut	52	Ladle Sleeve
11	Locknut	25	Sprocket	39	Bottom Hook Holder	53	Locknut
12	Rachet Cover	26	Stripper	40	Bottom Hook Assembly		
13	Hand Cover Assembly	27	Right Side Plate Assembly	41	End Chain Ring		
14	Locknut	28	Disc Gear	42	Handle Sleeve		



BLACK PAW MANUAL CHAIN LEVER HOIST - LEVER SPECIFICATIONS

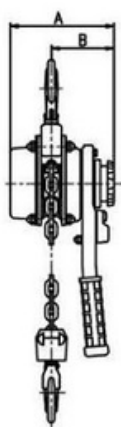

0.75T - 3T

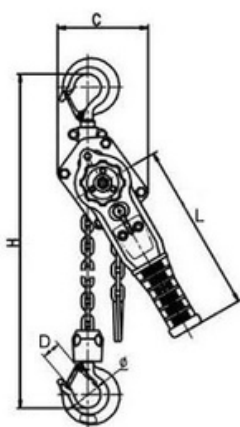

6T

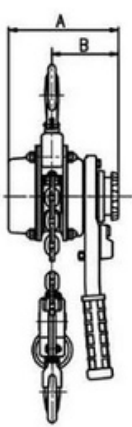

9T

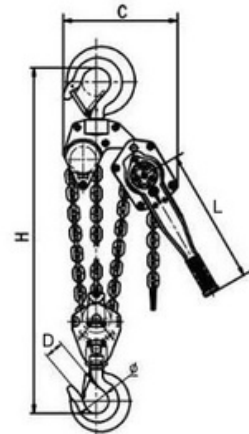
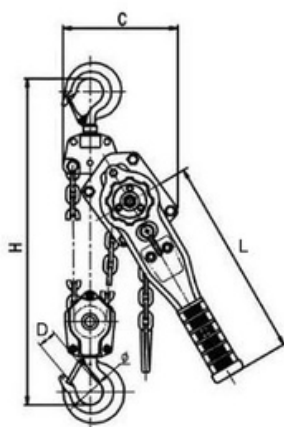

Model	0.5T	0.75T	1T	1.5T	2T	3T	6T	9T
Capacity	0.5	0.75	1	1.5	2	3	6	9
Standard Lift (M)	1.5	1.5	1.5	1.5	1.5	1.5	1.5	1.5
Running Test (T)	0.75	1.125	1.5	2.25	3	4.5	7.5	11.25
Effort Required To Lift Max Load		140	140	240	240	320	340	360
No Of Falls To Load Chain	1	1	1	1	1	1	2	3
Load Chain Diameter (mm)	5	6	6	8	8	10	10	10
Dimensions	A	102	148	148	176	176	195	195
	B	80	88	88	102	102	109	109
	C	95	135	135	155	155	211	319
	D		32	32	36	36	46	57
	L		290	290	415	415	415	415
	H		320	320	380	380	480	600
Net Weight (kg)	3.5	7	7.5	11	11.5	19	32	47
Packing (LxWxH) (cm)	33.5x12.5x9	37x14x17	37x14x17	52x4x18	52x14x18	52x16x21	52x16x21	62x48.5x26